

Rivertide Suites

102 N Holladay Seaside, OR 97138

Call 877-871-8433 and ask for **The Conference for Festivals & Events** rates or

[Click Here to book direct for The Conference for Festivals & Events 2026!](#)

A valid credit card will be required at the time of reservations. It is recommended to call sooner as guest rooms are not blocked or held out of inventory. Individual guestroom cancellations must be received by **4:00PM Fourteen (14) days prior** to arrival date to avoid a cancellation fee equal to the first night's room revenue. Our guaranteed check in time is 4:00PM and check out is at 11:00AM.

Property Features Include:

Complimentary Continental Breakfast 7am-10am Daily

Exercise Room 8am-9pm, Business Center 7am-11pm

Enjoy a unique view of Seaside from the Crow's Nest, our rooftop deck.

Located 0.1 miles from the Seaside Convention Center. Walking distance!

Room Amenities, Layouts, and Special Pricing:

All our suites include a full kitchen with utensils, dining table, electric fireplace, washer & dryer, jetted tub, air conditioning, cable TV, hair dryer, iron, ironing board.



Studio/JUNIOR Suite
1 Queen / 1 Sofa Sleeper

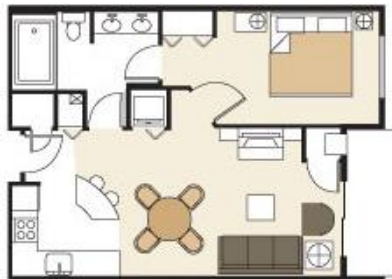

One Bedroom KING Suite
1 King / 1 Sofa Sleeper



Two Bedroom Two Bath KING Suite
1 King / 1 Queen / 1 Sofa Sleeper

Rates are valid for up to four adults. Any additional adults will be \$20 plus tax per night.

Room Type / View	Wednesday 2/25/26 & Thursday 2/26/26	Friday 2/27/26 & Saturday 2/28/26
Studio / JUNIOR Suite Mountain View & Sofa Sleeper	\$130 + Taxes & Fees	\$190 + Taxes & Fees
1 Bedroom KING Suite Mountain View & Sofa Sleeper	\$150 + Taxes & Fees	\$220 + Taxes & Fees
1 Bedroom KING Suite River View & Sofa Sleeper	\$175 + Taxes & Fees	\$245 + Taxes & Fees
2 Bedroom 2 Bath KING Suite Mountain View & Sofa Sleeper	\$205 + Taxes & Fees	\$275 + Taxes & Fees
2 Bedroom 2 Bath KING Suite River View & Sofa Sleeper	\$230 + Taxes & Fees	\$300 + Taxes & Fees

**All room rates are net, non-commissionable and subject to the prevailing lodging tax.*